



# Air operated Valve

Middle size 2-way diaphragm valve  
Size : 1/2", 3/4"

## FVAT 3040

### How to order 주문 방법

FVAT 3040 □ □ □ - □ □ □ - □ - □ - □ □ □  
① ② ③ ④ ⑤ ⑥ ⑦ ⑧ ⑨ ⑩ ⑪

① Body	② Upper Cover	③ Actuator	④ Operating	⑤ Connection		⑥ Option
T : PFA	E : PP V : PVDF S : PPS	E : PP V : PVDF S : PPS	C : Normal Close O : Normal Open D : Double Acting	4 : 1/2" 5 : 3/4"	Z : Z Fitting	0 : No Option 1 : Indicator 2 : Flow Control

⑦ O-Ring	⑧ Air Port Direction	⑨ Plate Material	⑩ Base Plate Type	⑪ Diaphragm
V : FKM (VITON) E : EPDM F : ETP K : FFKM N : NBR	1 2 3 4 	E : PP V : PVDF S : PPS	A : A Type Plate B : B Type Plate C : C Type Plate	P : PTFE T : TFM

### Specifications 사양

Orifice size	1/2" : 10mm	3/4" : 16mm
Connection size	1/2", 3/4"	
OP.Temp	5 ~ 80°C	
OP.Press(ordinary)	0 ~ 0.5MPa	
OP.Press(reverse)	0 ~ 0.5MPa	
Air Press	0.4 ~ 0.6MPa	
오리피스 치수	1/2" : 10mm	3/4" : 16mm
커넥션 치수	1/2" ~ 3/4"	
사용 온도	5 ~ 80°C	
사용 압력(정)	0 ~ 0.5MPa	
사용 압력(역)	0 ~ 0.5MPa	
작동 압력	0.4 ~ 0.6MPa	

### General 개요

This is medium diaphragm (1/2", 3/4" size). PTFE and PVC material are used for wetted parts which provide excellent chemical resistance. This is a valve for large flow rate such as LCD equipment. Various connection, 1/2" ~ 3/4", and other function of by-pass and flow controlling are also available.

1/2", 3/4" size의 중형 diaphragm valve입니다. 접액부는 PTFE, PVC 재질을 사용하여 우수한 내화학성을 지니고 있으며, LCD 장비 등의 대유량 valve에 적합합니다. 1/2", 3/4" 치수의 다양한 connection과 유량조절 by-pass 기능이 추가된 valve도 준비되어 있습니다.

### Features 특징

- Wetted parts can be supplied with PTFE or PVC
- Flare, PT female and Union connection
- NC, NO, Double Acting by air
- Indicator for movement's confirmation, flow control function
- Particle free, none ion contamination
- Ultrasonic washing by DI water & vacuum packing

- PTFE, PVC 접액부 선택
- Flare, PT female and Union connection
- Air 구동의 NC, NO, Double Acting
- 동작 확인용 indicator, 유량 조절 기능 부착
- Particle free, none ion contamination
- Degreasing, DI water로 초음파 세정 및 진공포장

### Applications 사용 분야

- Chemical supply system
- Wet station
- Spin etching, cleaning system
- Utility line
- LCD cleaning system
- LCD etching system

### Dimension 크기

설계 치수는 영업부에 문의 또는 승인도를 요청 바랍니다. 상기 치수는 변경될 수 있습니다.  
For exact size of each item, please contact sales dept. Above-mentioned dimension are changeable.

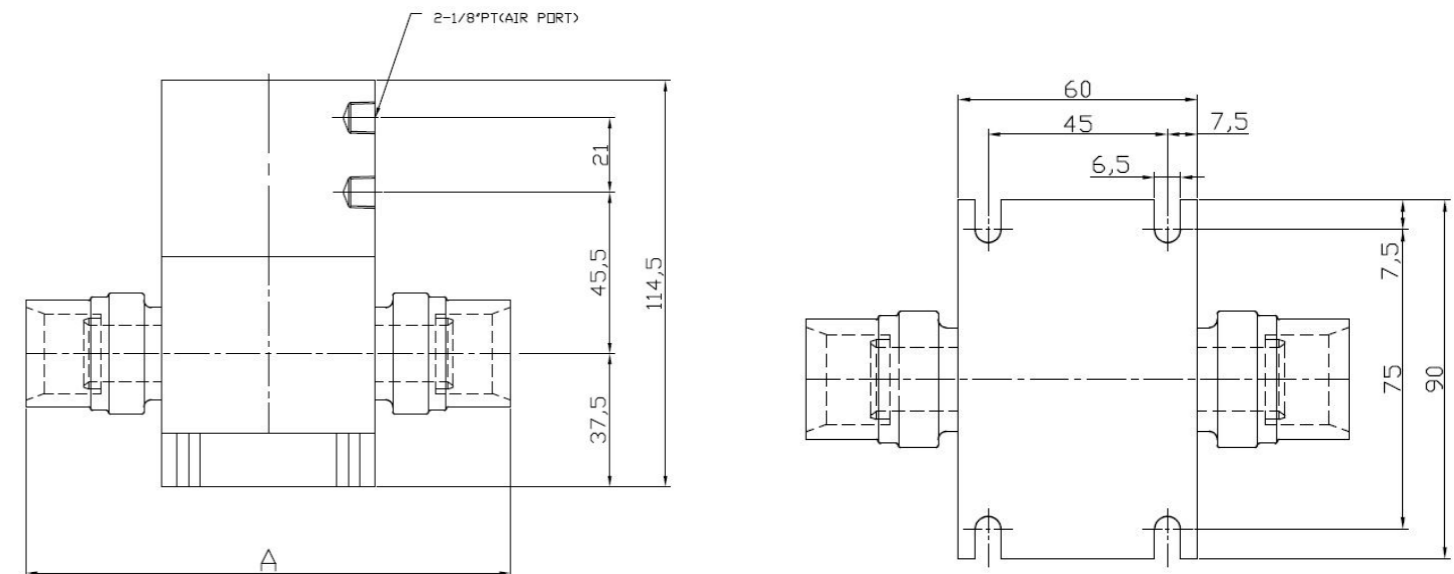

A	
1/2"	119mm
3/4"	136mm